

Mirror, Exterior  
Figure DJR-510

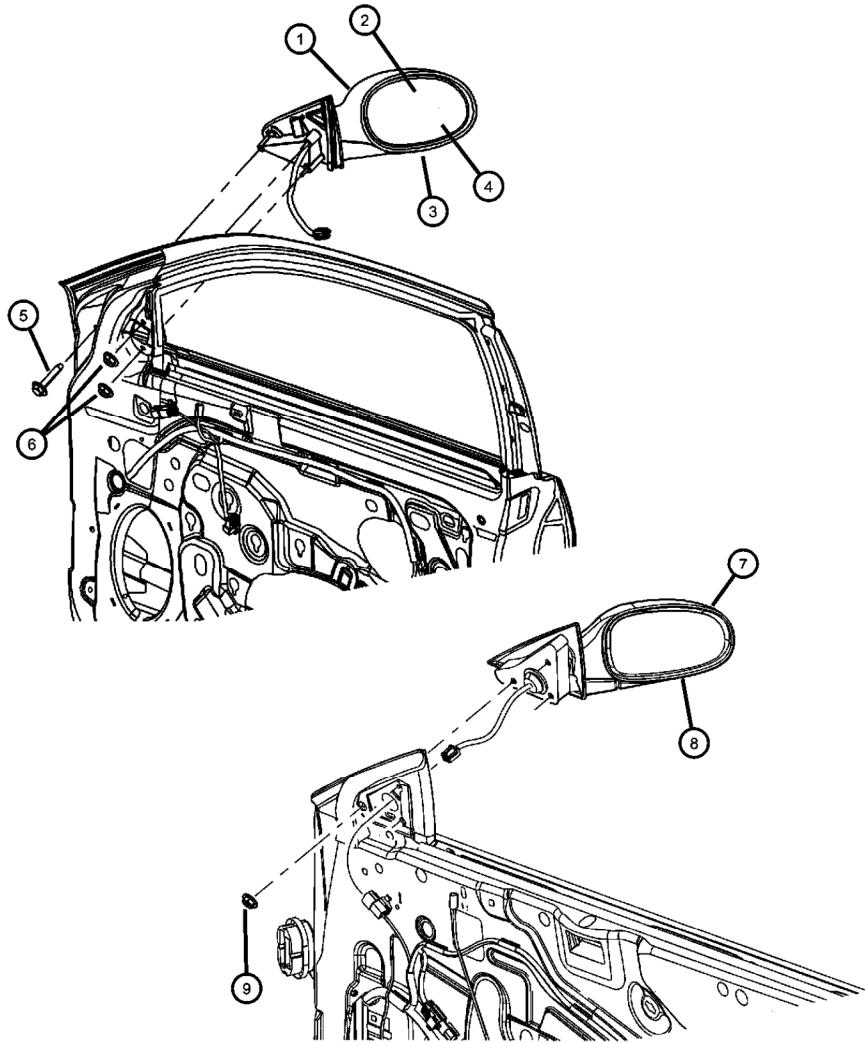

ITEM	PART NUMBER	QTY	LINE	SERIES	BODY	ENGINE	TRANS	TRIM	DESCRIPTION
------	-------------	-----	------	--------	------	--------	-------	------	-------------

Note: Sales Codes

[GTS] = Mirrors - Power Heated, Fold-Away

[GT3] = Mirrors - Power Fold-Away

[GUK] = Mirrors - Power Heated, Fold-Away

[GUR] = Mirrors - Power

1									MIRROR, Outside Rearview
	04805310AA	1			41				[GUR], Right
	04805311AA	1			41				[GUR], Left
	04805312AA	1			41				[GUK], Right
	04805313AA	1			41				[GUK], Left
2									GLASS, Mirror Replacement
	05018298AA	1			41				[GUR], Right
	05018299AA	1			41				[GUR], Left
	05069106AA	1			41				[GUK], Right
	05069107AA	1			41				[GUK], Left
3									MIRROR, Outside Rearview Electric Foldaway
	04805434AA	1			41				[GT3], Right
	04805435AA	1			41				[GT3], Left
4									GLASS, Mirror Replacement
	05069108AA	1			41				[GT3], Right
	05069109AA	1			41				[GT3], Left
5	06101952	2							SCREW, Hex Flange Head Tapping, M4.8 x 1.59 x 25.00
6	06101443	4			41				NUT AND WASHER, Hex, M5x.80
7									MIRROR, Outside, Rearview, Electric, Heated
	04805692AA	1	C		27				[GTS], Right
	04805693AA	1	C		27				[GTS], Left
8									MIRROR, Outside Rearview
	04805694AA	1	C		27				[GUK], Right
	04805695AA	1	C		27				[GUK], Left
9	06101443	4	C		27				NUT AND WASHER, Hex, M5x.80

SEBRING, STRATUS, CIRBUS, BREEZE (JR)

SERIES LINE

H = HIGHLINE D = STRATUS, ES

P = PREMIUM D = R/T (MEXICO)

S = SPORT C = SEBRING

X = SPECIAL C = CIRBUS (MEXICO)

BODY

27 = 2-DR CONVERTIBLE

41 = 4 DOOR

ENGINE

EDZ = ENGINE - 2.4L 4 CYL

DOHC 16V SMPI

ECC = ENGINE - 2.0L 4 CYL

DOHC 16V SMPI

EES = ENGINE - 2.7L V6 24V

W/ACTIVE INTAKE

EDV = Engine - 2.4L 4 Cyl

DOHC 16V Turbo

EEO = 2.7L V6 24V

ECO = ENGINES - ALL 2.0L 4

CYL

EDO = 2.4L 4 CYL 16V DOHCI

TRANSMISSION

DD5 = TRANSMISSION - 5-SPEED

MANUAL

DGL = TRANSMISSION - 4-SPD.

AUTOMATIC, 41TE

DGO = ALL AUTOMATIC

DDO = ALL 5 SPEED MAUAL

AR = use ase required - = Non illustrated part

2001 JR